

# Soils Map

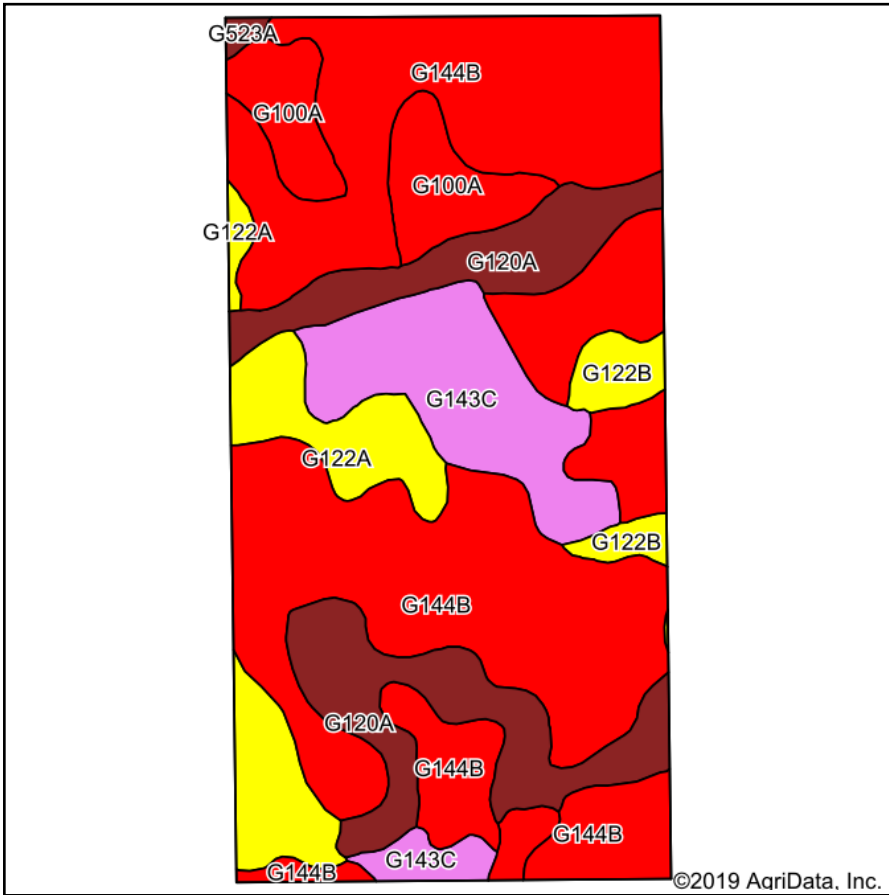

Soils data provided by USDA and NRCS.

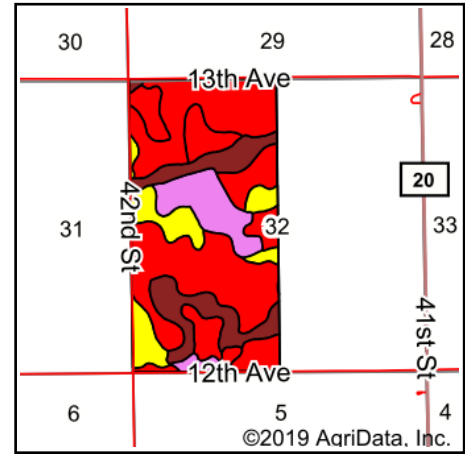





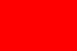

State: **North Dakota**  
 County: **Grand Forks**  
 Location: **32-151N-55W**  
 Township: **Larimore**  
 Acres: **321.68**  
 Date: **1/14/2019**

Maps Provided By:  
  
 CUSTOMIZED ONLINE MAPPING  
 © AgriData, Inc. 2019 [www.AgriDataInc.com](http://www.AgriDataInc.com)



## Area Symbol: ND035, Soil Area Version: 22

Code	Soil Description	Acres	Percent of field	PI Legend	Water Table	Restrictive Layer	Septic Limits	Foundation Limits	Soil Drainage	Non-Irr Class *c	Productivity Index
G144B	Barnes-Buse loams, 3 to 6 percent slopes	174.77	54.3%		4.9ft.	> 6.5ft.	somewhat limited	somewhat limited	Well drained	IIIe	69
G120A	Vallers, saline-Manfred complex, 0 to 1 percent slopes	47.96	14.9%		0.7ft.	0.7ft. (Natric)	very limited	very limited	Poorly drained	IVw	37
G143C	Barnes-Buse-Langhei loams, 6 to 9 percent slopes	36.37	11.3%		> 6.5ft.	> 6.5ft.	somewhat limited	not limited	Well drained	IVe	55
G122A	Svea-Cresbard loams, 0 to 3 percent slopes	28.93	9.0%		4ft.	> 6.5ft.	very limited	somewhat limited	Moderately well drained	IIc	79
G100A	Hamerly-Tonka complex, 0 to 3 percent slopes	24.44	7.6%		0.5ft.	> 6.5ft.	very limited	very limited	Somewhat poorly drained	Ile	64
G122B	Barnes-Cresbard loams, 3 to 6 percent slopes	8.21	2.6%		4.9ft.	> 6.5ft.	somewhat limited	somewhat limited	Moderately well drained	Ile	72
G523A	Lowe-Fluvaquents, channeled complex, 0 to 2 percent slopes, frequently flooded	1.00	0.3%		2.5ft.	> 6.5ft.	very limited	very limited	Poorly drained	VIw	21
<b>Weighted Average</b>											<b>63.1</b>

\*c: Using Capabilities Class Dominant Condition Aggregation Method

Soils data provided by USDA and NRCS.